



**industrial production
special economic zone**

Pskov region, Russia



01. Geographical location. Transport accessibility

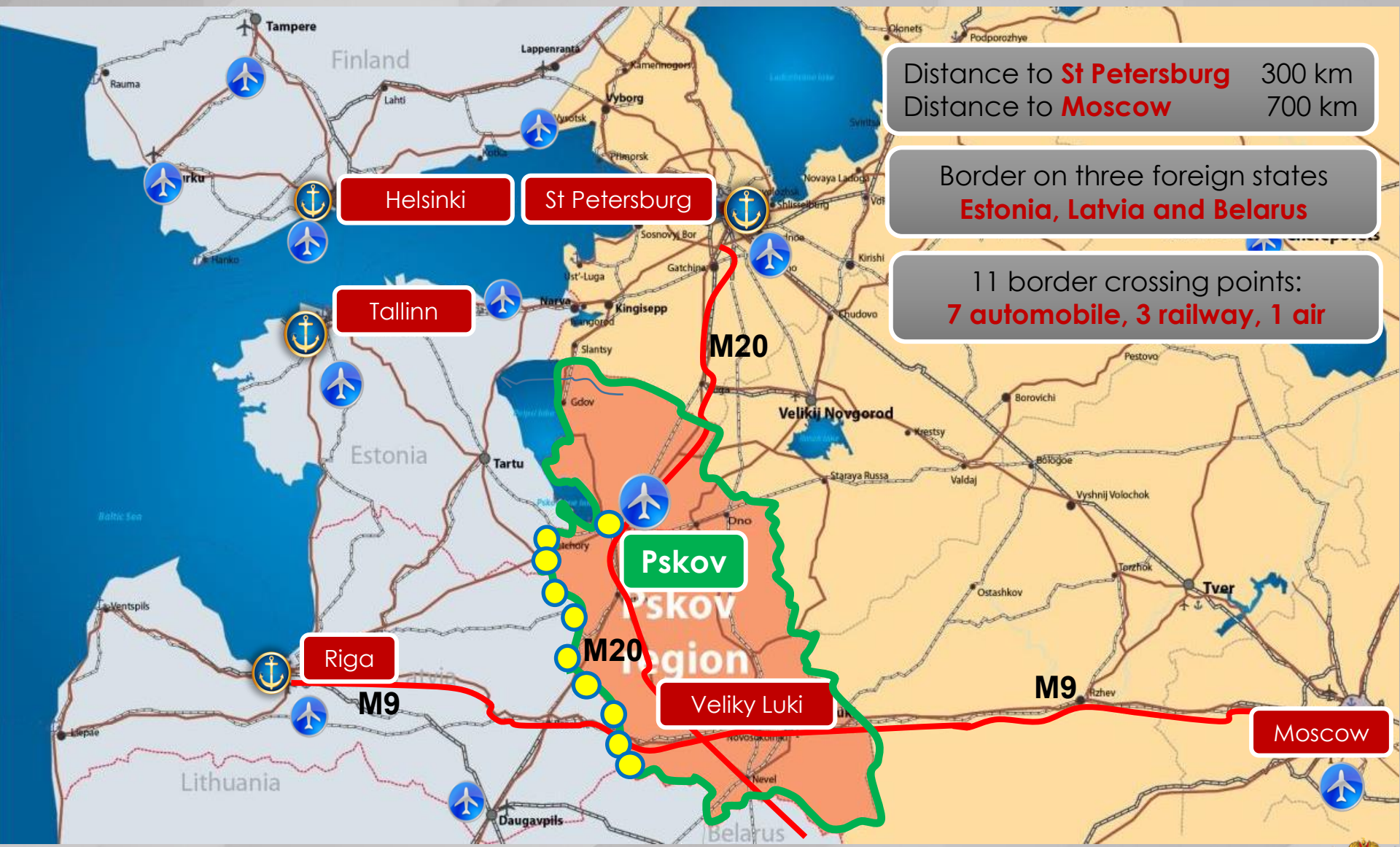

Distance to **St Petersburg** 300 km
 Distance to **Moscow** 700 km

Border on three foreign states
Estonia, Latvia and Belarus

11 border crossing points:
7 automobile, 3 railway, 1 air



02. High economic and industrial potential

GDP structure

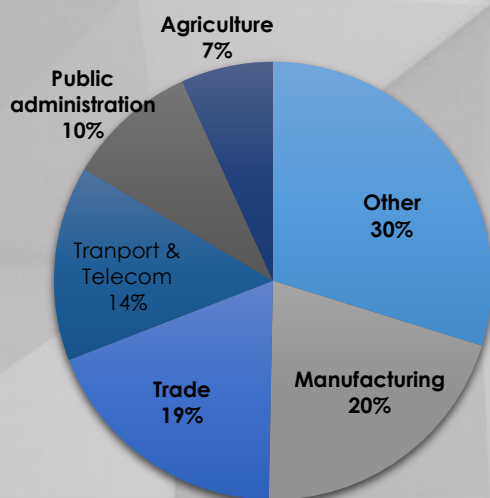

Industrial complex structure

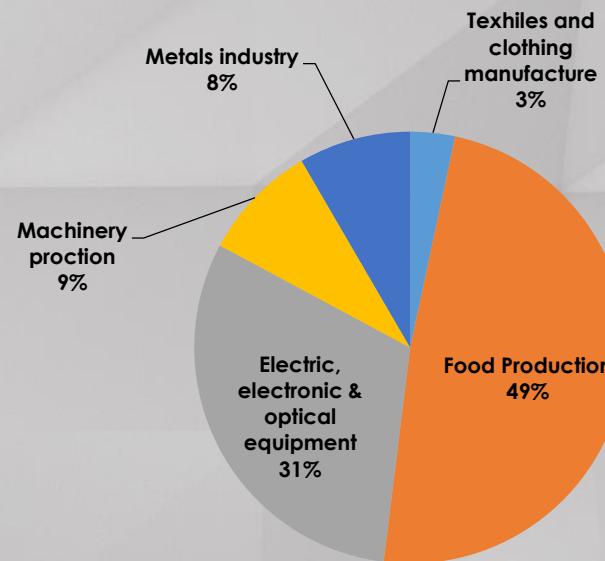

Companies in priority economy sectors

Branch	No of companies
Agro-industrial complex	58
Transport & logistics	89
Construction	11
Light manufacturing	28
Forest industry	83
Tourism	52
Electric equipment and machinery	42

Current key economy branches:

- Electrical equipment
- Cables & wires
- Electric welding equipment
- Car electrical equipment
- Lifting machinery



03. Urban integration

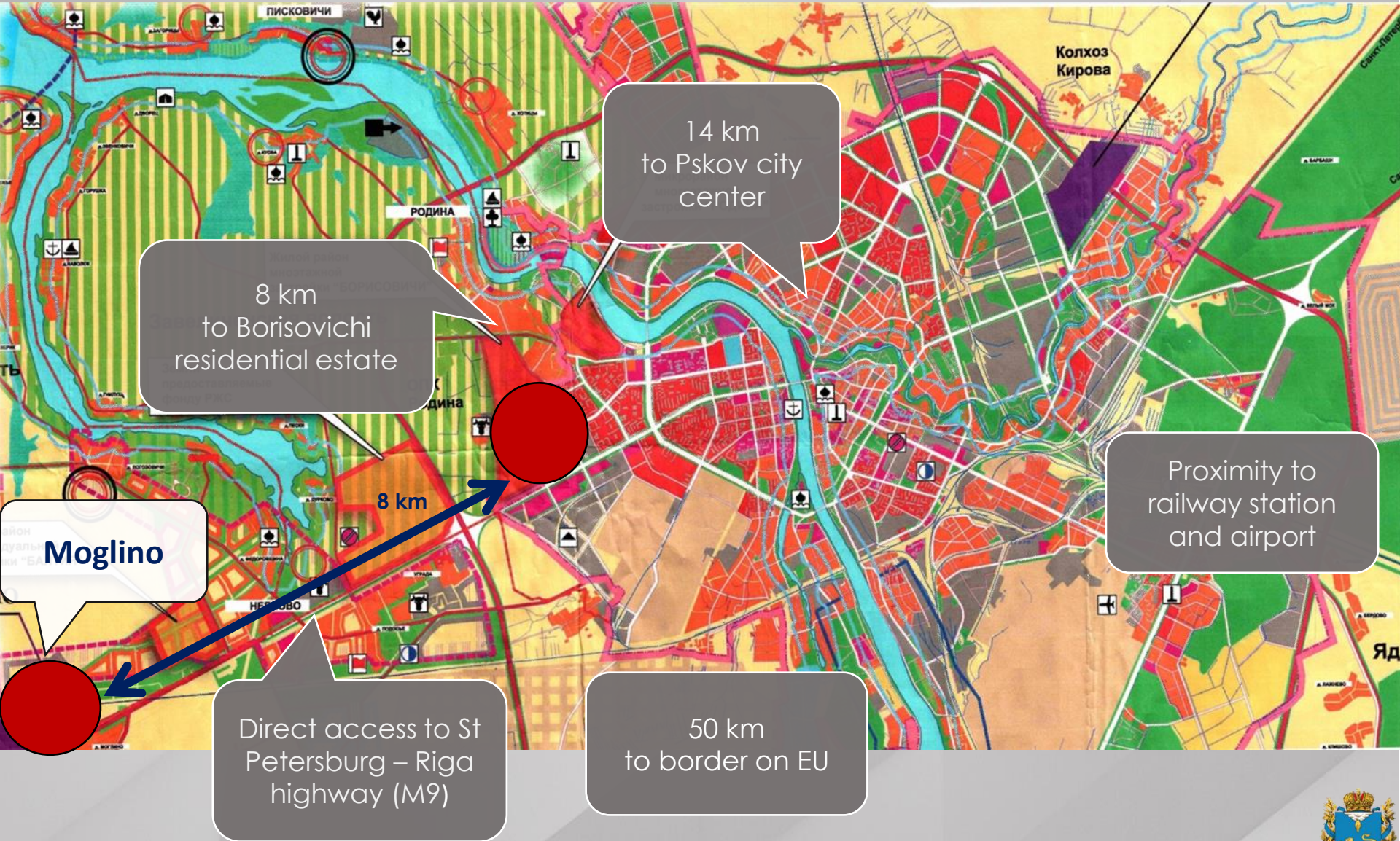

04. Moglino SEZ localization

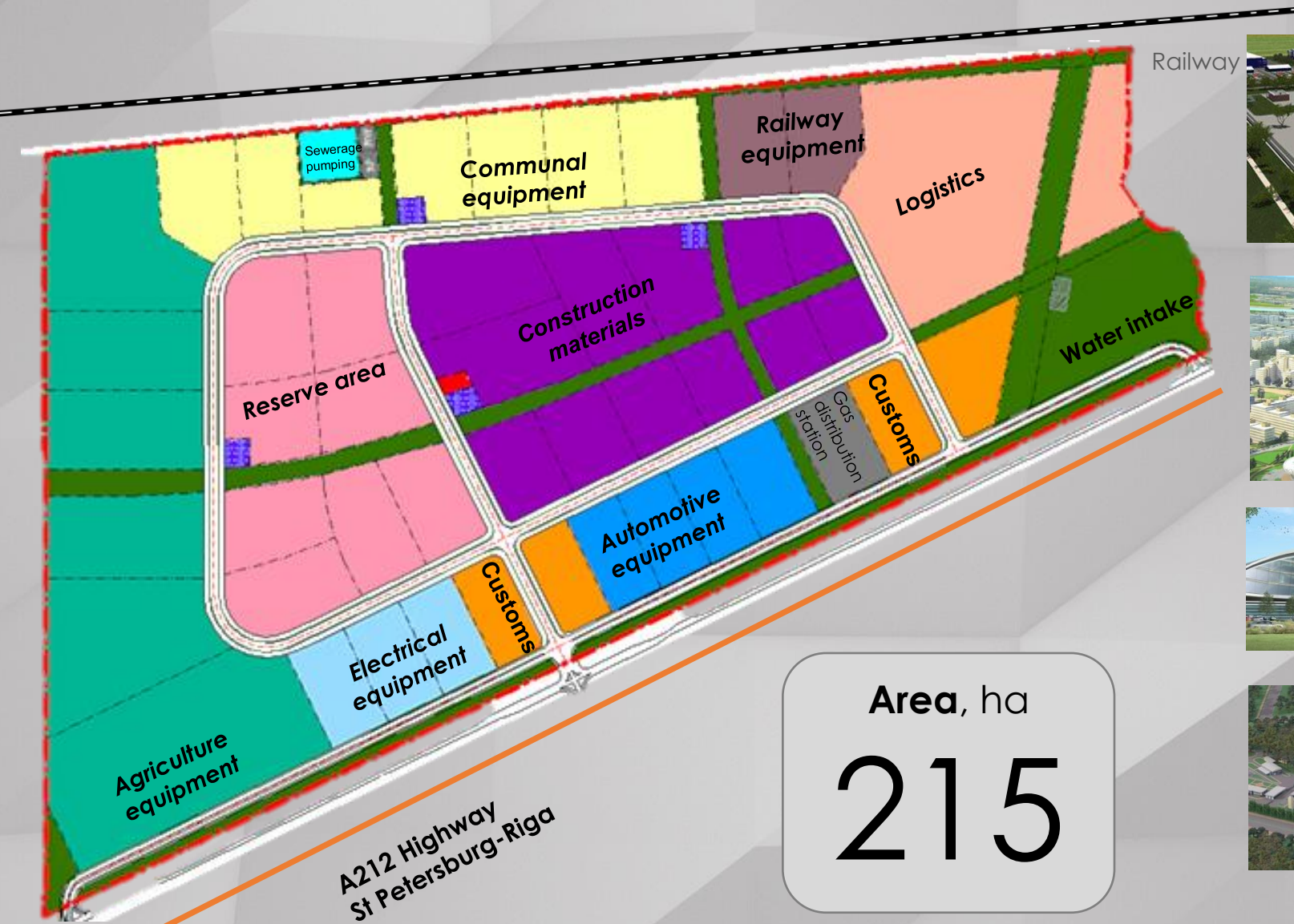

Area, ha
215

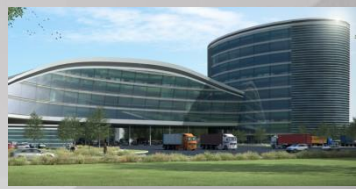

05. Automotive components production cluster

Pskov already produces the following components:

- Transportable load-lifting machines
- Caterpillar tractors
- Fire-fighting machinery
- Tank trunks
- Car electric motors, relays,
- Insulated wires and cables, galvanic elements and batteries
- Gear-reduction boxes for snow-clearing vehicles
- Drive gears
- Transfer gearboxes for asphalt spreaders

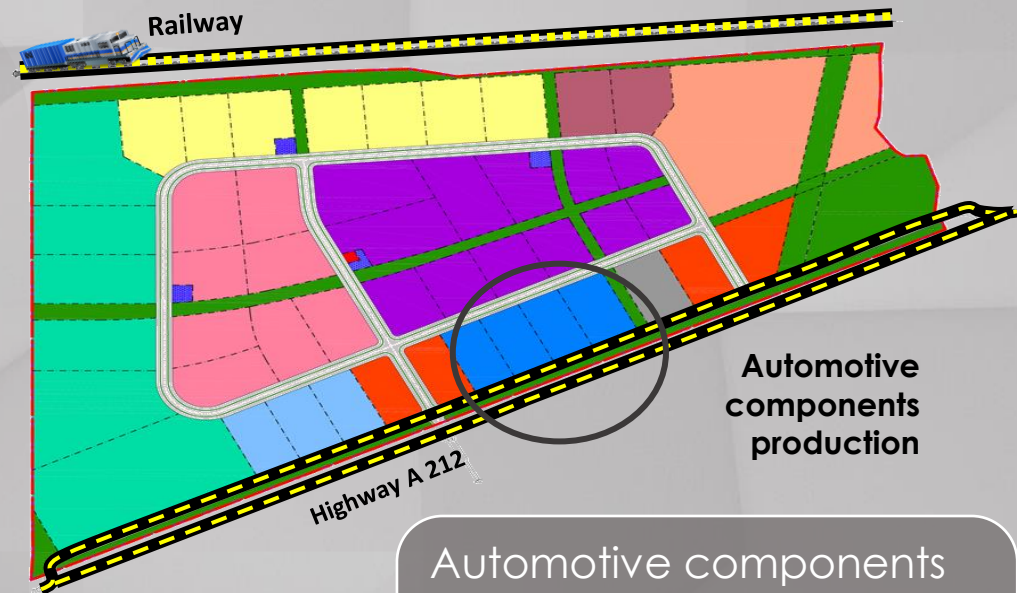

Automotive components cluster – **8,3 ha**
Land lots from **1 ha** of different configurations



Pskov factories supply to:
Hyundai Motor Manufacturing Russia,
EMERCOM, AutoVAZ, GAZ,
GM-AutoVAZ, GM-Uzbekistan, KamAZ,
MAZ, UAZ, ZAZ



06. Automotive components producers in the Pskov region



YURA Corporation (Korea)

Production: electric wires & harness



Tochlit factory

Production: carbon steel, alloy steel, gray-cast and special iron casting



Pskov factory of mechanical drives

Production: reduction gear boxes, gear-motor drives, motor drums, drives



Forest machinery



Lifting machinery



Avtoelectroarmatura (AVAR)

Production: electric components for cars, trucks and agriculture equipment:

- relays
- fuses
- switches, electric mounting blocks, electronic components

For: AVTOVAZ, GM-AVTOVAZ, AZ GAZ, UAZ, KAMAZ, MAZ



AC / DC motors

Car electric equipment



07. Potential Sales Market for Automotive Components

The Pskov Region is situated not far from the main centers of consumption of Russia and Europe



Location	Travel Time	Distance (km)
St Petersburg	3 hours	294 km
Moscow	8 hours	730 km
Helsinki, Finland	8 hours	700 km
Tallinn, Estonia	4 hours	350 km
Riga, Latvia	3 hours	280 km
Kaunas, Lithuania	5 hours	570 km
Minsk, Belarus	7 hours	500 km
Kiev, Ukraine	11 hours	930 km



Boundaries on three foreign countries

Estonia, Latvia and Belarus

11 border-crossing checkpoints:

**1 airport, 7 automobile and
3 railway**

Major production and consumption centers:

St Petersburg and Moscow:

Volkswagen, Toyota, Ford, Hyundai, GM, Renault;

Belarus – MAZ

Kaliningrad – KIA

Tatarstan – Ford Sollers, KAMAZ

Ulyanovsk – UAZ

Krasnoyarsk – KAZ



08. Workforce

3200
graduates annually



30% engineers
30% workers



Training programs:

Power and electric engineering

Metallurgy, machine engineering
and material processing

Design and construction

Food and consumer goods
technology

Economics and management

Service and hospitality



Average salary (November 2013), EUR

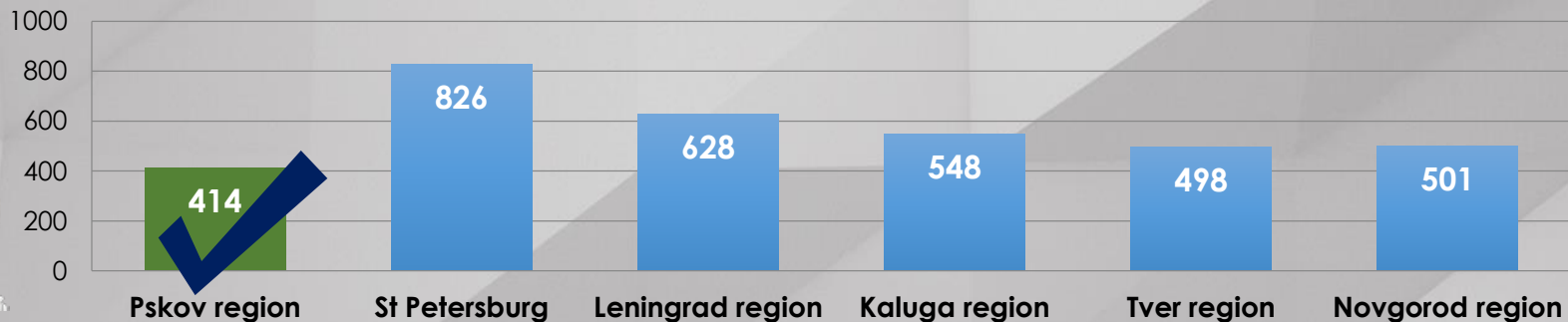



Special
economic
zone
MOGLINO

Thank you for your attention!

Moglino SEZ, JSC

Pskov, Lenina str., 17

tel/fax 8(81 12)68-20-80

E-mail: sez.moglino@gmail.com

www.moglino.com

